



Installation Guide: Thin Veneer Products

Surface Preparation:

Thin Veneer Products may be installed over most any masonry surface or interior/exterior framed wall. All surfaces should be clean and dry and void of debris or loose material. All building materials, material sizes/ gauges, and application techniques should be in compliance with both local building codes and manufacturer requirements. Installation in temperatures below 40°F is not recommended.



We recommend the use of type S mortar coupled with an acrylic bonding agent mixed per the manufacturer's instructions.



Installation of a weep system such as Masonry Technology's Sure-Cavity™ can create an effective percolation system for exterior moisture or interior condensation where needed and/or desired.

Framed Walls (*sheetrock, greenboard, or wood sheathing*), *figure 1:*

Install a vapor barrier (two-ply 15# felt or better) taking care to provide sufficient overlap both on the sides and top/bottom. Install galvanized diamond mesh expanded metal lath (2.5 lb. or higher recommended) with galvanized fasteners (or equivalent) 16" on center minimum, and every 6" vertically. Fasteners should penetrate underlying studs at least 1". Corner applications should overlap the lath installed on the wall flats by at least 4". Apply a 1/2" scratch coat and allow to cure thoroughly (24 hours).

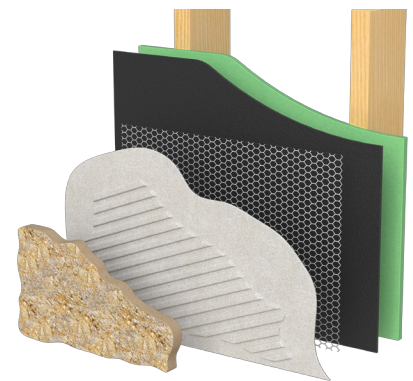

figure 1

Framed Walls (*concrete board*), *figure 2:*

Unless mandated by local codes, no specific surface preparation is required. If necessary, however, follow the instructions for sheetrock, greenboard and wood sheathing above EXCEPT for the vapor barrier, which should not be installed.



figure 2

Visit any of our ten convenient locations at:
swensongranite.com



Installation Guide: Thin Veneer Products

New Masonry (block or poured wall), figure 3a:

No specific surface preparation is required. For poured walls, be certain that all surfaces are void of any residual form release agents. If necessary, clean with muriatic acid, rinse, and allow to dry completely.

Existing Masonry (painted or sealed concrete, block or brick), figure 3b:

Sandblast the entire surface to remove paint and/or sealer, rinse, and allow to dry completely, OR install galvanized diamond mesh expanded metal lath (3.4 lb. recommended) with concrete screws or nails and apply a 1/2" scratch coat. Scratch coat should be allowed to cure thoroughly (24 hours).

Insulated Concrete Forms, figure 4:

Apply a vapor barrier followed by a weep system and expanded metal lath (as above) taking care to use fasteners of sufficient length to adequately penetrate the poured wall. Apply a 1/2" scratch coat and allow to cure thoroughly (24 hours).



figure 3a

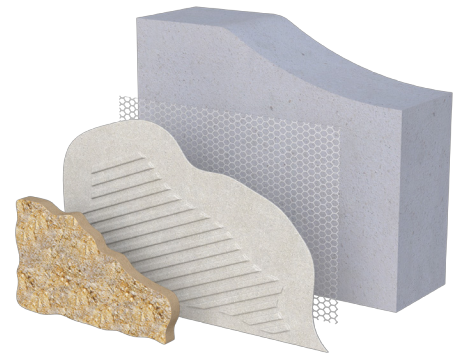

figure 3b

Cavity weep system installed directly over the vapor barrier

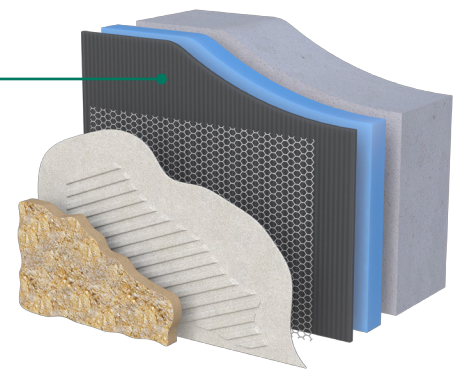

figure 4

Thank you once again for choosing Swenson Stone Works as your supplier of fine manufactured granite products.

Visit any of our ten convenient locations at:
swensongranite.com