



Price List 2023

Prices effective: January 2023



**DO IT ONCE.
DO IT WITH STONE.**

A **POLYCOR** COMPANY

Granite Steps

Cut from our own **WOODBURY GRAY™** granite, our steps offer a wide variety of beautiful styles to choose from, and all of them will offer you a lifetime of maintenance-free enjoyment. We carry an extensive supply, in a wide assortment of stock sizes, at all of our Stone Works locations to fit most applications, and we will gladly produce steps to your specifications. Our stock steps are 7" thickness. See our Granite Step Worksheet on page 12!



SPLIT FACE
Natural guillotine edges, thermal top.

Stock lengths*: 3'-0" to 8'-0"

Stock widths: 1'-1", 1'-6", 2'-0", 3'-0", 4'-0"

Price per square foot: **\$52.00**

** Lengths come in full foot increments*



ROCK FACE
Heavy relief, hand cut (chiseled) edges, thermal top, sawn backs.

Stock lengths*: 3'-0" to 8'-0"

Stock widths: 1'-1", 1'-6", 2'-0", 3'-0", 4'-0"

Price per square foot: **\$63.00**

** Lengths come in full foot increments*



SAINT HENRY BLACK® GRANITE STEPS
Thermal top, front & ends, sawn balance.

4'-0" x 1'-4" x 7": **\$675.00** each

SAINT HENRY BLACK® STEP FILLERS
1'-2" x 6" x 7": **\$105.00** each
2'-4" x 6" x 7": **\$210.00** each



RADIUS STEPS (½ moon)
Heavy relief, hand cut (chiseled) edges, thermal top.

4'-0" long, 2'-0" wide: **\$649.00** each

6'-0" long, 3'-0" wide: **\$1,415.00** each

8'-0" long, 4'-0" wide: **\$2,499.00** each

All of our steps are available in other thicknesses and colors priced upon request. Approximately 97 lbs. per square foot.

STEP FILLERS
Stock size: **\$29.00** per linear foot.

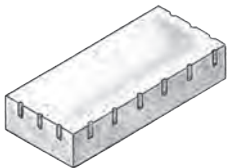

YANKEE STYLE
Drilled and split edges with drill holes exposed, thermal top.

Price per square foot: **\$64.00**

Custom order only

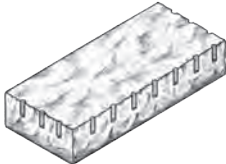

OLD YANKEE STYLE
Drilled and split edges and top with drill holes exposed.

Price per square foot: **\$101.00**

Custom order only



CUSHION EDGE
Natural guillotine sides, eased antiqued edges, thermal top.

Price per square foot: **\$64.00**

Custom order only

Granite Treads | Hearths | Mantels | Wall Caps

Cut from **WOODBURY GRAY™** or **CALEDONIA™** granite, (thermal top and split face edges, sawn bottom), and **INDIANA LIMESTONE™** (rock face front edge, sawn balance). These are perfect for adding the finishing touch to your stone or brick steps, fireplace, and decorative walls.

	2" THICKNESS STOCK LENGTHS*	2" THICKNESS STOCK WIDTHS*	2" THICKNESS PRICE PER SQ. FT.	4" THICKNESS STOCK LENGTHS*	4" THICKNESS STOCK WIDTHS*	4" THICKNESS PRICE PER SQ. FT.
WOODBURY GRAY™ granite	4'-0" to 8'-0"	8" 1'-0" 1'-2" 1'-6"	1'-8" 2'-0" 3'-0" 4'-0" \$33.99	4'-0" to 8'-0"	8" 1'-0"	\$48.99
CALEDONIA™ granite	4'-0" to 8'-0"	1'-0"	\$37.99			
INDIANA LIMESTONE - Classic gray color	4'-0" to 8'-0"	1'-0"	\$18.39			

Other sizes, finishes, and colors available and quoted separately, including: *BETHEL WHITE®*, *CALEDONIA™*, *AUTUMN PINK*, *DEER ISLE* and *CAMBRIAN BLACK®* granites.

Mailbox Posts

Replace your unsightly mailbox post and enjoy our granite mailbox post for a lifetime. We carry our most popular styles in stock, all are 7" x 7" x 7'-0", and include a black single-scroll wrought iron mailbox bracket mounted on the post. Other bracket options and styles are available. See supplemental price list.



EASTERN GRAY™ granite		CALEDONIA™ granite
Split Face-2 Thermal-2: \$405.00 each	Rock Face-2 Thermal-2: \$469.00 each	Rock Face-2 Thermal-2: \$525.00 each

Engraving

Your address, street or family name, or just about anything else you can think of, can be sandblasted into any of our posts, and will be brought to life using long-lasting litho-chrome paint. Standard engraving costs are \$170.00 for the first thermal side, \$115.00 for the second thermal side, and include up to four characters (up to 3" high each) per side. Additional characters, logos, etc. are quoted separately. **We can also engrave benches, signs, pavers and more. Ask your sales associate for more details.**

Delivery and Installation

Swenson Stone Works can deliver any of our products to your home or job site, and will even install a front set of steps, a lamp post, or mailbox post. Ask your Swenson Stone Works representative for details and pricing.

Granite Posts

Our classic **EASTERN GRAY™** granite posts are great for fences, entry gates, establishing property lines and more. We stock them at 7'-0" long, with a hand-chiseled 5'-0" reveal on all rock face finishes.



Sides are:	SAWED-2 SPLIT FACE-2	THERMAL-2 SPLIT FACE-2	THERMAL-2 ROCK FACE-2	OLD YANKEE (DRILLED & SPLIT)	ROCK FACE 4 SIDES	APPROX. WEIGHT PER POST
6" x 6"	\$209.00 each	\$225.00 each	\$269.00 each	N/A	\$579.00 each	300 lbs.
7" x 7"	\$245.00 each	\$275.00 each	\$335.00 each	\$589.00 each	\$679.00 each	400 lbs.
10" x 10"	\$395.00 each*	\$425.00 each	\$519.00 each	\$930.00* each	\$1,200.00 each*	800 lbs.
12" x 12"	\$459.00 each*	\$519.00 each	\$615.00 each	\$1,090.00* each	\$1,505.00 each*	1200 lbs.

*Other sizes and colors available and quoted separately.

Street Number / 911 I.D. post

Highly visible, permanent address marker for 911 identification for your home.



6" x 6" x 5'-0"

EASTERN GRAY™ granite post, thermal-2 sides, split face-2 sides finish, with up to four numbers engraved.

\$365.00

Hitching Posts

These posts add an old-fashioned charm to your yard, walkway and driveway.



6" x 6" x 5'-0"

EASTERN GRAY™ granite, thermal-2 sides, split face-2 sides finish, black wrought iron ring installed

\$289.00

Lamp Posts

Light up your yard, walkway, driveway or business with our classic granite lamp posts. Each post comes drilled for wiring, and ready to accept mounting hardware and your lamp fixture (see lamp flange kit below). All in-stock lamp posts come with a thermal-2 sides, rock face-2 sides finish. Lamp fixtures are not included.



	DIMENSIONS	WEIGHT	PRICE
EASTERN GRAY™ granite	6" x 6" x 4'-6" (low-profile)	200 lbs.	\$325.00 each
	6" x 6" x 8'-0"	375 lbs.	\$505.00 each
	7" x 7" x 8'-0"	490 lbs.	\$569.00 each
CALEDONIA™ granite	7" x 7" x 8'-0"	490 lbs.	\$649.00 each
Lamp Flange Kit	3" diameter aluminum flange with tube of epoxy		\$53.00 each

Lamp Post Caps & Pillar Caps

Top off the classic look of your granite post or stone pillar with one of our hand-crafted granite caps. Lamp post caps are drilled through the middle to line up with the hole in your lamp post. Pillar caps are split face on all four sides, and add a bold statement to your stone pillar.

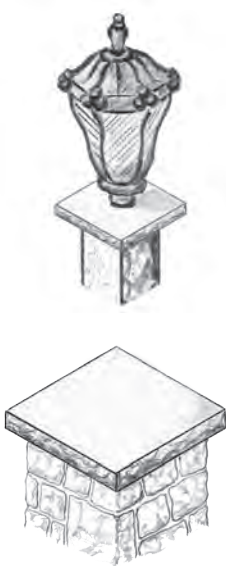

	DIMENSIONS	STYLE	PRICE
WOODBURY GRAY™ granite Lamp Post Caps	8" x 8" x 2"	Rock face four sides	\$129.00 each
	10" x 10" x 2"	Rock face four sides	\$145.00 each
	8" x 8" x 2"	Four-sided apex top	\$245.00 each
	10" x 10" x 2"	Four-sided apex top	\$255.00 each
CALEDONIA™ granite	10" x 10" x 2"	Rock face four sides	\$159.00 each
WOODBURY GRAY™ granite Pillar Caps	24" x 24" x 4"	Split face four sides	\$215.00 each
	26" x 26" x 4"	Split face four sides	\$225.00 each
	32" x 32" x 4"	Split face four sides	\$349.00 each
	36" x 36" x 4"	Split face four sides	\$409.00 each

Other colors include: BETHEL WHITE®, CALEDONIA™, AUTUMN PINK, DEER ISLE and CAMBRIAN BLACK® granites.

Bound Posts

EASTERN GRAY™ granite permanent boundary marker for your property or subdivision, each has a 3⁄8" diameter hole, drilled 1⁄2" deep on top.

	2'-0" LONG	3'-0" LONG	4'-0" LONG
4" x 4"	\$39.00 each	\$51.00 each	\$63.00 each
6" x 6"		\$69.00 each	\$85.00 each

Granite Signs

Make a statement about your business, school, country club or other organization with one of our custom granite signs. With a variety of colors and finishes, coupled with our creative sales staff and production crew, we will work with you to make your vision a reality. See our website and color brochure for some ideas, or bring your concept, logos and other artwork and we will create a lasting symbol you will be proud to display for all to see.

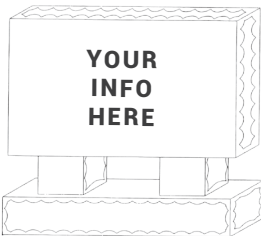



STONE	SIZE	THICKNESS	PRICE
PAVERS			
WOODBURY GRAY™ granite - Thermal top, sawn balance	11 5/8" x 11 5/8" up to 23 5/8" x 35 5/8"	1 1/2"	\$25.89 / sq. ft.
WOODBURY GRAY™ granite - XL Paver - Thermal top, sawn balance	35 5/8" x 35 5/8" and 47 5/8" x 23 5/8"	1 1/2"	\$31.89 / sq. ft.
CALEDONIA™ granite - Thermal top, sawn balance	11 5/8" x 11 5/8" up to 23 5/8" x 35 5/8"	1 1/2"	\$27.69 / sq. ft.
NEW SAINT HENRY BLACK™ granite - Thermal top, sawn balance*	12x12, 12x24, 18x24, 24x24, 24x36	1 1/2"	\$32.39 / sq. ft.
NEW GEORGIA MARBLE™ - PEARL GREY - Sandblast top, sawn balance	12x12, 12x24, 18x24, 24x24, 24x36	1 1/2"	\$35.19 / sq. ft.
INDIANA LIMESTONE - FULL COLOR BLEND™ - Sawn all surfaces	11 5/8" x 11 5/8" up to 23 5/8" x 35 5/8"	1 1/2"	\$13.99 / sq. ft.

STEP & FILLERS - SAINT HENRY BLACK™ granite

Steps - Thermal top, front, and both ends, sawn balance	4'-0" x 1'-4"	7"	\$675.00 each
Step Fillers - Thermal one long face, sawn balance	14"	N/A	\$105.00 each
	28"	N/A	\$210.00 each

TREADS, SILLS, THIN VENEER - INDIANA LIMESTONE - FULL COLOR BLEND™

Sills - Rock face front, sawn balance, with a drip edge underneath	4'-0" x 3"	2 1/4"	\$6.35 / L.F.
Sills - Rock face front, sawn balance, with a drip edge underneath	4'-0" x 4"	2 1/4"	\$8.45 / L.F.
Flats - Rockford Estate Blend - thin veneer** Tumbled front, sawn balance, multiple heights	150 sq. ft. crate 25 sq. ft. crate	varies	\$16.79 / sq. ft. \$18.49 / sq. ft.
Flats - Berkshire® - thin veneer** - Split face front, sawn balance, 3 heights	150 sq. ft. crate 25 sq. ft. crate	varies	\$16.79 / sq. ft. \$18.49 / sq. ft.
Corner - Rockford Estate Blend - thin veneer** Tumbled front, sawn balance, multiple heights	150 l.f. crate 25 l.f. crate	varies	\$20.99 / L.F. \$22.75 / L.F.
Corner - Berkshire® - thin veneer** - Split face front, sawn balance, 3 heights	150 l.f. crate 25 l.f. crate	varies	\$20.99 / L.F. \$22.75 / L.F.

**Thin veneer sold by the full crate only



STONE	SIZE	THICKNESS	PRICE
GARDEN WALLS - INDIANA LIMESTONE - FULL COLOR BLEND™			
INDIANA LIMESTONE™ - Garden Wall	8" wide and random length approx. 21 face feet per ton	3"	\$759.00 ton
INDIANA LIMESTONE™ - Garden Wall	8" wide and random length approx. 21 face feet per ton	6"	\$759.00 ton
INDIANA LIMESTONE™ - Wall cap	24" x 12" size. Rock face both long edges, sawn balance	2"	\$49.00 each

THIN VENEER AND POOL COPING - WOODBURY GRAY™ granite			
WOODBURY GRAY™ granite - Berkshire® - thin veneer** Split face front, sawn balance, 3 heights	Flats - 25 s.f. crate - sold by full crate only		\$34.99 / sq. ft.
	Flats - 150 s.f. crate - sold by full crate only		\$30.29 / sq. ft.
WOODBURY GRAY™ granite - Berkshire® - thin veneer** Split face front, sawn balance, 3 heights	Corners - 25 l.f. crate - sold by the full crate only		\$43.59 / L.F.
WOODBURY GRAY™ granite - Pool Coping Thermal top and one long chamfered edge, sawn balance.	12" x 24" x 2"	N/A	\$155.00 each

* Modular cut, i.e.: 12" x 12" actually 11⅝" x 11⅝", etc.

** All material is ¾" to 1¼" thickness on average, ideal for covering over brick, block, concrete, drywall and wood applications. Other colors and stone types available upon request, such as square and rectangular, ledge, and Ashlar patterns.

Most of our thin veneer is available in a full bed version (3" to 5" bed depth) as well. Please ask your sales associate for pricing and ordering details.

Other **POLYCOR** Hardscapes & Masonry products available on request, all full pallet quantities: ask your sales associate for more details

BETHEL WHITE® granite	Pavers, including XL pavers. Pool coping, wall cap, pillar caps, treads.
INDIANA LIMESTONE™	Pavers in gray and buff. XL paver sizes, pool coping, fossil Beige color, pillar caps, varying tread & sill sizes, garden benches, boulders, full bed veneer.
SAINT HENRY BLACK® granite	XL pavers, pool coping, wall cap, pillar caps, treads.
CALEDONIA™ granite	XL pavers.
GEORGIA MARBLE™ - PEARL GREY	XL pavers, pool coping, garden wall, wall cap, pillar caps, landscape steps, treads, garden benches, full bed veneer, thin sawn veneer, sills.

Outdoor Living



Granite mill wheels, compasses, and fire pits offer some beautiful ways to bring a touch of elegance and function within your overall landscaping design. Other sizes, colors* and finishes are available and quoted separately.

ROUND FIRE PITS

- 16 blocks per tier, 7" thick
- Approx. 50lbs. per block

	EASTERN GRAY™ granite, sawn joint	CALEDONIA™ granite, sawn joint
1-Tier Fire Pit	\$1,490.00	\$1,630.00
2-Tier Fire Pit	\$2,390.00	\$2,670.00
3-Tier Fire Pit	\$3,290.00	\$3,710.00
<i>*All pricing includes metal insert with tilt back cooking grate.</i>		
30" diameter cast iron ring and tilt-back cooking grate (included in above pricing)		\$590.00
Same as above, with a removable cooking grate		\$920.00
30" diameter cast iron ring (no cooking grate)		\$460.00
Round iron fire pit screen		\$510.00

SQUARE FIRE PITS

- 10 blocks per tier, 7" thick
- Approx. 70lbs. per block

	EASTERN GRAY™ granite, sawn joint
1-Tier Fire Pit	\$1,535.00
2-Tier Fire Pit	\$2,225.00
3-Tier Fire Pit	\$2,915.00
<i>*All pricing includes metal insert with tilt back cooking grate.</i>	
Square iron fire pit screen	\$379.00
28" square cast iron insert and tilt-back cooking grate (included in square pricing above)	\$845.00
28" square cast iron insert (no cooking grate)	\$709.00

XL SQUARE FIRE PITS

SAINT HENRY BLACK™ granite

4 pieces, 3'-0" x 1'-4" x 7" each. Thermal top, one long and both short edges, sawn balance. Creates a 28" square fire opening.

\$2,300.00 total
(insert not included, see above for pricing)



ANTIQUED MILL WHEELS

2'-6" Diameter 4" Thick	\$1,015.00 each
4'-0" Diameter 7" Thick	\$1,969.00 each
4'-0" x 2'-0" x 7" ½ Moon Step	\$845.00 each
6'-0" x 3'-0" x 7" ½ Moon Step	\$1,595.00 each

**Other mill wheel designs are possible, and are quoted separately. CUSTOM ORDER ONLY*

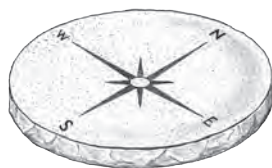

COMPASSES : Thermal top, rock face edges. Other designs and wording can be engraved onto our compasses, and are quoted separately.

WOODBURY GRAY™ granite	Size	Engraved	Blank
Compass or Chessboard	2'-6" diameter, 2" thick	\$679.00 each	\$395.00 each
Compass or Chessboard	1'-6" diameter, 2" thick	\$505.00 each	\$239.00 each
Compass	2'-0" diameter, 2" thick	\$579.00 each	\$295.00 each

Other colors include: BETHEL WHITE®, CALEDONIA™, AUTUMN PINK, DEER ISLE and CAMBRIAN BLACK® granites.

CUSTOM ORDER ONLY

Granite Benches

Our granite benches are handcrafted from many granite colors for anyone's taste.* We have an excellent supply of stock benches in a variety of finishes, and we have a granite bench for any budget. Custom-made benches are available and priced upon request. All pricing includes bases.

STANDARD RECTANGULAR

48" x 14" x 4" thick bench top, split face all edges

TOP FINISH	WOODBURY GRAY™
Sandblast	\$395.00 each
Polished	\$429.00 each

CLASSIC RECTANGULAR

48" x 14" x 4" thick bench top, rock face all edges

TOP FINISH	WOODBURY GRAY™
Sandblast	\$575.00 each
Polished	\$615.00 each

CLASSIC LARGE RECTANGULAR

60" x 14" x 4" thick bench top, rock face all edges

TOP FINISH	WOODBURY GRAY™
Sandblast	\$625.00 each
Polished	\$689.00 each

ANTIQUE STYLE RECTANGULAR

48" x 14" x 4" thick bench top, antiqued edges

TOP FINISH	WOODBURY GRAY™
Sandblast or Thermal	\$595.00 each

SEAT WALL STYLE BENCH

72" x 18" x 18" sandblasted radius top and ends, rock face front and back

WOODBURY GRAY™	\$2,085.00 each
----------------	-----------------

**Other colors available as custom order, including BETHEL WHITE®, CALEDONIA™, AUTUMN PINK, DEER ISLE and CAMBRIAN BLACK® granites are available and quoted separately.*

STANDARD KIDNEY STYLE

46" long, 4" thick bench top, rock face all edges, rectangular bases

TOP FINISH	WOODBURY GRAY™
Sandblast	\$510.00 each
Polished	\$539.00 each

CLASSIC KIDNEY STYLE

51" long, 6" thick bench top, rock face all edges, round bases

TOP FINISH	WOODBURY GRAY™
Sandblast	\$889.00 each
Polished	\$920.00 each

CLASSIC TREE STYLE

48" x 14" x 4" curved bench top, rock face all edges

TOP FINISH	WOODBURY GRAY™
Sandblast	\$679.00 each
Polished	\$700.00 each

PARK STYLE BENCH W/ BACKREST

Sandblast or polished seat and backrest, rock face all edges

LENGTH	WOODBURY GRAY™
48" Long w/arched back	\$2,375.00 each \$2,460.00 each
60" Long w/arched back	\$2,605.00 each \$2,705.00 each
72" Long w/arched back	\$2,860.00 each \$2,975.00 each

SEATS

WOODBURY GRAY™

Lo-boy Seat round granite seat and 12" high round base (polished or sandblast top). Perfect for around our fire pits!	\$275.00 each
--	---------------

**Other colors include: BETHEL WHITE®, CALEDONIA™, AUTUMN PINK, DEER ISLE and CAMBRIAN BLACK® granites. CUSTOM ORDER ONLY*

Granite Bird Baths

You and your winged friends will enjoy the classic good looks of our granite bird baths. We combine handwork and state-of-the-art equipment to provide you with exceptional quality and function. All of our bird baths can be left outside year-round. Other colors* may be available, and are quoted separately.

WOODBURY GRAY™	
Octagon Style: octagon bath and square base	\$229.00 each
Lo-boy Style: round bath and 12" high round base	\$340.00 each
Standard Apex Style: round bath and 18" high base	\$375.00 each
Classic Apex Style: round bath and 36" high pedestal	\$465.00 each

*Other colors include: BETHEL WHITE®, CALEDONIA™, AUTUMN PINK, DEER ISLE and CAMBRIAN BLACK® granites. **CUSTOM ORDER ONLY**

Granite Edging

Give your driveway, walkway or garden area the distinguished look of our **EASTERN GRAY™** granite edging. All of our edging has a thermal top, and split face four edges, and is stocked in varying lengths, from 3'-0" to 8'-0" (most commonly 3'-0" to 6'-0"). We will also gladly cut any of our granite edging to specific lengths for an additional charge.

	SIZE	PRICE PER L.F.	APPROX. WEIGHT PER L.F.
Economy Edging	3" x 4" x random length	\$7.49	14 lbs.
Garden Edging	3" x 7" x random length	\$9.19	25 lbs.
Driveway Edging	4" x 7" x random length	\$12.29	32 lbs.
Heavy Edging Can also be used as Step Risers, cut to length.	4" x 12" x random length	\$20.09	56 lbs.

Granite Curbing

Typically used along town and state roads, our high quality gray granite curbing is also great for large parking lots and driveways. Any curbing can be cut to specific lengths at an additional cost. Produced to order and priced upon request.

STRAIGHT VERTICAL CURBING RANDOM LENGTHS ONLY, FROM 4'-0" TO 10'-0"			
WIDTH	SIZE	PRICE PER L.F.	APPROX. WEIGHT PER L.F.
4"	17" +/- 1"	\$21.40	80 lbs.
5"	17" +/- 1"	\$27.60	100 lbs.
6"	18" +/- 1"	\$33.65	120 lbs.

CIRCULAR VERTICAL CURBING Produced to order and priced upon request. Linear footage and number of pieces is determined by outside arc measurement.			
---	--	--	--

SLOPE CURBING RANDOM LENGTHS ONLY, FROM 4'-0" TO 10'-0"			
WIDTH	SIZE	PRICE PER L.F.	APPROX. WEIGHT PER L.F.
3½"	11" +/- 1"	\$17.95	43 lbs. Mass slope
4"	12" +/- 1"	\$19.95	56 lbs. Mass slope
5"	12" +/- 1"	\$23.50	70 lbs. ME slope
6"	12" +/- 1"	\$24.50	83 lbs. NH slope

Glossary of Terms

ROCK FACE	Heavy relief, hand cut (chiseled) finish.
SPLIT FACE	Natural grain split, produced by hydraulics or wedges and shims.
SAWN	Dull, smooth finish created by wire or diamond saw. May show blade marks.
THERMAL	Slightly pebbled, non-slip finish produced by applying high temperature flame.
SANDBLAST	Slightly textured, produced with abrasives under high pressure.
POLISHED	Mirror gloss finish, achieved by rubbing the stone with a series of abrasives.
ANTIQUED	(cushion edge) Mottling of edges and corners with high temperature flame.
HONED	Non-reflective dull sheen finish achieved by rubbing the stone with a series of abrasives.
BUSH-HAMMERED	A corrugated finish, with interrupted parallel markings, produced by utilizing pneumatic tools.
OLD YANKEE	Drilled and split by hand, using wedges and shims. Very rustic appearance.

Please note: prices may change without notice due to cost fluctuations of raw materials.



Scan the QR Code for more resources.



Swenson Stone Works Granite Step Worksheet



A POLYCOR COMPANY

Pad Size: _____

Notes:

A) Length: _____

B) Height: _____

C) Depth: _____

D) Depth: _____

E) Threshold Height: _____

F) Overall Length
(to outside of trim)



NATURAL STONE Price List 2023

Prices effective: April 2023



DO IT ONCE.
DO IT WITH STONE.

A **POLYCOR** COMPANY

Cobblestones



These tumbled cobbles lend that rustic, old world look to your landscaping design.

JUMBO approx. 10" x 7" x 4" (102 or 105 pcs./plt.)	
Gray	\$7.95 each
Rose	\$10.35 each
Black	\$13.65 each
Yellow	\$13.99 each
JUMBO THIN approx. 10" x 7" x 3" (102 or 105 pcs./plt.)	
Gray	\$7.59 each
STANDARD approx. 9" x 5" x 5" (146 or 150 pcs./plt.)	
Gray	\$5.99 each
Rose	\$8.85 each
Black	\$9.89 each
Yellow	\$9.99 each
CUBES approx. 4" x 4" x 4" (500 pcs./plt.)	
Gray	\$2.09 each
Rose	\$2.59 each
Black	\$3.59 each
Yellow	\$3.59 each
CLASSIC GRAY FULL-SIZE approx. 12" x 6" x 3" (140 pcs./plt.)	
Gray	\$10.35 each
CLASSIC GRAY HALF-SIZE approx. 6" x 6" x 3" (294 pcs./plt.)	
Gray	\$4.15 each
LANDSCAPE GRAY approx. 8" x 4" x 4" (250 pcs./plt.)	
Gray	\$4.59 each

Granite & Stone Pavers

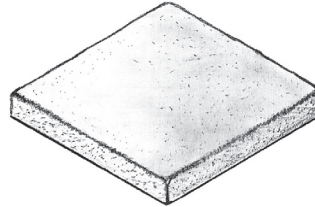

Ideal for walkways, patios and stepping paths, granite pavers hold up to anything Mother Nature can throw at them, and they weather beautifully.

PATTERN PAVERS All pavers are thermal top, sawn balance, and are stocked in sizes ranging from 12" x 12" to 24" x 36", in 6" increments (modular cut, i.e.: 12" x 12" actually 11 1/2" x 11 1/2", etc.).		
BLUE MIST	1 1/4" thick	\$18.39 / sq. ft.
BUSH-HAMMERED PAVERS Finished by hand, these pavers have one tumbled side, and one side with a bush-hammered finish, and work well for a variety of uses.		
Stock sizes all approx. 2 1/2" thick	6" x 12"	\$37.50 / sq. ft.
	12" x 12"	
	12" x 18"	
	12" x 24"	
	18" x 18"	
	18" x 24"	
	24" x 24"	
	24" x 30"	
	24" x 36"	
	30" x 30"	

Bluestone treads / hearths / mantels / wall caps

	FULL FOOT INCREMENTS STOCK LENGTHS	STOCK WIDTHS	2" THICKNESS PRICE PER SQ. FT.
BLUESTONE Premium blue-gray color, thermal top, front and ends, with a sawn smooth balance.	4'-0" to 8'-0"	1'-0"	\$34.89
		1'-2"	\$34.89
		1'-8"*	\$37.65
		2'-0"*	\$37.65

Other sizes available and quoted separately.
*Limited availability for these widths.

Flagstone

Ideal products for walkways, patios and stepping stones, we offer a variety of colors and shapes.

IRREGULAR FLAGSTONE		COLONIAL SLABS	
All sold by pallet (averaging 1.5 to 2 tons per pallet), and coverage will vary with product type. Most available by pound for smaller projects.		PRICE	
	PRICE		
Tumbled Bluestone Mosaic approx. 1.5 tons	\$845.00 / pallet	Large 4-5 pcs./pallet, 3" to 4" thick, up to 4' x 6'	\$585.00 / pallet
Tumbled Bluestone Mosaic Half Pallets approx. .75 tons	\$499.00 / pallet	XL 2-3 pcs./pallet, 3" to 4" thick, up to 5' x 8'	\$785.00 / pallet
Irregular Bluestone approx. 1.5 tons	\$839.00 / pallet	XXL 1-2 pcs./pallet, 3" to 5" thick, up to 6' x 6'	\$835.00 / pallet
Premium Blue Select Thermal Top Irregular Bluestone - approx. 1.5 tons	\$1,599.00 / pallet	XXXL 1 pc./pallet, 3" to 6" thick, over 6' x 6'	\$1,029.00 / pallet
Large Tumbled Irregular Bluestone approx. 1.5 tons	\$1,215.00 / pallet	PATTERN BLUESTONE	
Weathered Fieldstone Flagging approx. 1.5 tons	\$665.00 / pallet	All are 1½" thick (natural cleft products will vary between 1¼" and 2" thick), and stocked from 12" x 12" to 24" x 36" in 6" increments (modular cut, i.e.: 12" x 12" actually 11½" x 11½", etc).	
Large Weathered Fieldstone Flagging approx. 1.5 tons	\$619.00 / pallet	PRICE	
Tumbled Colonial Garden Path approx. 1.5 tons	\$689.00 / pallet	Full Color Bluestone natural cleft top, sawn edges	\$10.89 / sq. ft.
Ticonderoga Granite Flagging (while supplies last)	\$759.00 / ton	Blue Select Bluestone natural cleft top, sawn edges	\$14.79 / sq. ft.
Saratoga Granite Flagging (while supplies last)	\$745.00 / ton	Thermal Top Full Color Bluestone sawn edges	\$15.45 / sq. ft.
South Bay Quartzite Flagging	\$895.00 / ton	Thermal Top Blue Select Bluestone sawn edges	\$17.99 / sq. ft.
Old Chester Granite Flagging	\$529.00 / ton	Tumbled Bluestone Pavers 12" x 12" eased, antiqued edges	\$16.45 each
Large Old Chester Granite Flagging	\$729.00 / ton	Tumbled Bluestone Pavers 12" x 18" eased, antiqued edges	\$24.69 each
Green Mountain Granite Flagging	\$679.00 / ton		
Laredo Blend Flagging	\$1,489.00 / ton		
Vermont Slate	Starting at \$.49 / lb.		
Colonial Stepping Stones	\$679.00 / pallet		
Weathered Stepping Stones	\$579.00 / pallet		
Old Chester Granite Steps 36" to 48" Long, 18" to 24" Wide, 6" to 8" Thick	\$96.00 / sq. ft.		

Thin Veneer Stone

All material is ¾" to 1¼" thickness on average, ideal for covering over brick, block, concrete, drywall and wood applications. Other colors and stone types available upon request, such as square and rectangular, ledge, and Ashlar patterns. *Most of our thin veneer is available in a full bed version (3" to 5" bed depth) as well. Please ask your sales associate for pricing and ordering details.*

FLATS Use this material for the body of area you are covering.

	MOSAIC	SQUARE & RECT.
American Granite	\$33.99 / sq. ft.	\$33.99 / sq. ft.
Corinthian Granite	\$26.39 / sq. ft.	\$26.39 / sq. ft.
South Bay Quartzite	\$26.39 / sq. ft.	\$26.39 / sq. ft.
1763 Granite	\$33.99 / sq. ft.	\$33.99 / sq. ft.
Old Chester Granite	\$15.99 / sq. ft.	special order only
Green Mountain Granite	\$16.85 / sq. ft.	special order only
Boston Blend	\$21.59 / sq. ft.	special order only
Connecticut Blend	\$18.09 / sq. ft.	special order only
CT Wthd. Fieldstone	\$16.69 / sq. ft.	special order only
Old Spruce Mountain	\$16.69 / sq. ft.	special order only
Hispania	\$16.69 / sq. ft.	special order only
Hampshire Ridge	\$16.99 / sq. ft.	special order only
ROUND		
River Valley	\$16.99 / sq. ft.	
Old Redding	\$19.09 / sq. ft.	
Boston Blend	\$28.65 / sq. ft.	
Old New England	\$22.85 / sq. ft.	
LEDGE		
Boston Blend	\$23.69 / sq. ft.	
Connecticut Blend	\$19.65 / sq. ft.	

CORNERS Finish off your corners and match your flats beautifully. Measured by the height of each individual corner.

	MOSAIC	SQUARE & RECT.
American Granite	\$40.39 / l.f.	\$40.39 / l.f.
Corinthian Granite	\$30.69 / l.f.	\$30.69 / l.f.
South Bay Quartzite	\$30.69 / l.f.	\$30.69 / l.f.
1763 Granite	\$40.39 / l.f.	\$40.39 / l.f.
Old Chester Granite	\$23.99 / l.f.	special order only
Green Mountain Granite	\$26.05 / l.f.	special order only
Boston Blend	\$35.89 / l.f.	special order only
Connecticut Blend	\$25.99 / l.f.	special order only
CT Wthd. Fieldstone	\$30.89 / l.f.	special order only
Old Spruce Mountain	\$30.89 / l.f.	special order only
Hispania	\$30.89 / l.f.	special order only
Hampshire Ridge	\$28.99 / l.f.	special order only
ROUND		
River Valley	\$28.99 / l.f.	
Old Redding	\$31.29 / l.f.	
Boston Blend	\$35.89 / l.f.	
Old New England	\$29.19 / l.f.	
LEDGE		
Boston Blend	\$35.89 / l.f.	
Connecticut Blend	\$29.29 / l.f.	

Wallstone (1/2)

Ideal for decorative and retaining walls on your property. All material sold by the full pallet, 1.5 to 2 tons per pallet, unless otherwise marked. Approximate coverage is 15 cubic feet per ton.

MOSAIC PATTERN

BY THE TON	REGULAR	THIN
Old Chester Granite	\$425.00	\$469.00
Green Mountain Granite	\$489.00*	\$469.00

**Limited supplies - Call for availability*

WHILE SUPPLIES LAST

BY THE TON	REGULAR	THIN
Ticonderoga Granite	\$555.00	\$609.00
Saratoga Granite	\$535.00	\$609.00
South Bay Quartzite	\$499.00	\$559.00

Wallstone (2/2)

Ideal for decorative and retaining walls on your property. All material sold by the full pallet, 1.5 to 2 tons per pallet, unless otherwise marked. Approximate coverage is 15 cubic feet per ton.

MOSAIC PATTERN			BY THE PALLET	APPROX. WEIGHT	PRICE PER PALLET
BY THE PALLET	APPROX. WEIGHT	PRICE PER TON			
Saratoga Cottage Wallstone	1.25 tons avg.	\$619.00	Castle Mountain Wallstone	1.25 tons avg.	\$529.00
Ticonderoga Cottage Wallstone	1.25 tons avg.	\$619.00	Half Pallets Weathered Fieldstone	.75 ton	\$359.00
South Bay Quartzite Cottage Wallstone	1.25 tons avg.	\$619.00	Weathered Field Stone Regular and Thin	1.5 tons	\$615.00
			Old New England Fieldstone	1.5 tons	\$785.00
			Round Old New England Fieldstone	1.5 tons	\$785.00
			Half Pallets Colonial Wallstone	.75 tons	\$299.00
			Colonial Wallstone	1.5 tons	\$469.00
			Weathered Quarry Wallstone	1.5 tons	\$785.00
			Weathered Fieldstone Boulder variety of sizes/pieces per pallet	1.5 tons	\$499.00

Wrought Iron & Aluminum Accessories

All accessories have long-lasting black powdercoat paint applied to them.

	PRICE	INSTALLED ON GRANITE
Single-Scroll Mailbox Bracket standard on stock mailbox posts	\$110.00 each	\$130.00 each
Double-Scroll Mailbox Bracket	\$162.00 each	\$182.00 each
Mail and Paper Box Bracket, Single Scroll	\$140.00 each	\$160.00 each
Mail and Paper Box Bracket, Double Scroll	\$200.00 each	\$220.00 each
Round Newspaper Tube	\$260.00 each	N/A
Aluminum Mailbox Bracket	\$150.00 each	\$170.00 each
Square Aluminum Newspaper Box	\$180.00 each	N/A
Mailbox Bracket, "L" Shape	\$108.00 each	\$128.00 each
Double Mailbox Bracket fit two boxes side-by-side	\$156.00 each	\$176.00 each
Mailbox Kit includes box, mounting plate and hardware	\$73.00 each	N/A
Hitching Ring	\$53.00 each	\$73.00 each
Hitching Ring (Stem Only)	\$29.00 each	\$49.00 each
Fence Rail Hanger for 4 X 4 Railing	Wrought Iron:	\$41.00 each
	Aluminum:	\$44.00 each
Stockade/Picket Fence Hanger	\$23.00 each	\$33.00 each
Sign Bracket - Small	\$136.00 each	\$156.00 each
Sign Bracket - Large	\$185.00 each	\$205.00 each
Plant Hanger - Single Arm	\$134.00 each	\$154.00 each
Plant Hanger - Double Arm	\$207.00 each	\$237.00 each

Azek products

	PRICE	INSTALLED ON GRANITE
Azek Mailbox Bracket	\$440.00 each	\$465.00 each
Azek Mailbox Bracket w/Newspaper Box	\$500.00 each	\$525.00 each
Azek Mailbox Post Cap	\$190.00 each	N/A
Azek Lamp Cap & Flange, for 6" x 6" lamp post	\$275.00 each	N/A
Azek Lamp Cap & Flange, for 7" x 7" lamp post	\$290.00 each	N/A

Stone Cutting Tools

	CARBIDE	STEEL
7/8" Hand Point	165.00 each	\$145.00 each
Heavy Hand Point	175.00 each	N/A
2" Hand Set	\$240.00 each	\$195.00 each
2" Offset Hand Set	\$249.00 each	\$205.00 each
2" Tracer	\$230.00 each	\$195.00 each
2" Heavy Tracer	\$255.00 each	N/A
16 oz. Bush Hammer	\$385.00 each	N/A
3 lb. Striking Hammer	N/A	\$225.00 each
3/8" Wedge and Shim Set	N/A	\$16.25 set
1/2" Wedge and Shim Set	N/A	\$17.25 set
5/8" Wedge and Shim Set	N/A	\$18.25 set
3/4" Wedge and Shim Set	N/A	\$21.75 set

Other heavy hammers and specialty chisels also available at all locations. We stock a good assortment of lifting straps, tie-downs and protective corners. Please ask your sales associate for more details.

	PRICE
4" Diamond Blade	\$59.00 each
7" Economy Diamond Blade	\$65.00 each
7" Diamond Blade	\$145.00 each
10" Diamond Blade	\$255.00 each
12" Diamond Blade	\$305.00 each
14" Economy Diamond Blade	\$215.00 each
14" Diamond Blade	\$349.00 each
4" Diamond Cup Grinder	\$225.00 each
Curb Lifting Tongs	\$1,675.00 each
Step Lifting Clamps	\$3,300.00 each



**Scan the QR Code
for more resources.**



Notes & Planning

Notes & Planning

Notes & Planning

swensongranite.com

NOW OPEN!

EAST WAREHAM

3120 Cranberry Highway
East Wareham, MA 02538
508.492.1216

AMHERST

86 State Route 101A
Amherst, NH 03031
603.672.7827

CONCORD

369 North State Street
Concord, NH 03301
603.225.4322

HANOVER

742 Washington Street
Hanover, MA 02339
781.829.0233

MEDWAY

10 Main Street
Medway, MA 02053
508.533.2882

NEWTOWN

292 South Main Street
Newtown, CT 06470
203.270.6644

ROWLEY

125 Newburyport Turnpike
Rowley, MA 01969
978.948.3363

SHREWSBURY

874 Hartford Turnpike,
Shrewsbury, MA 01545
508.365.1340

SOUTH HADLEY

489 Granby Road,
South Hadley, MA 01075
413.322.8881

WESTBROOK

582 Bridgton Road
Westbrook, ME 04092
207.797.4500